

CAILLASSES  
EXPLORATIONS OF A TERRITORY  
IN TRANSITION

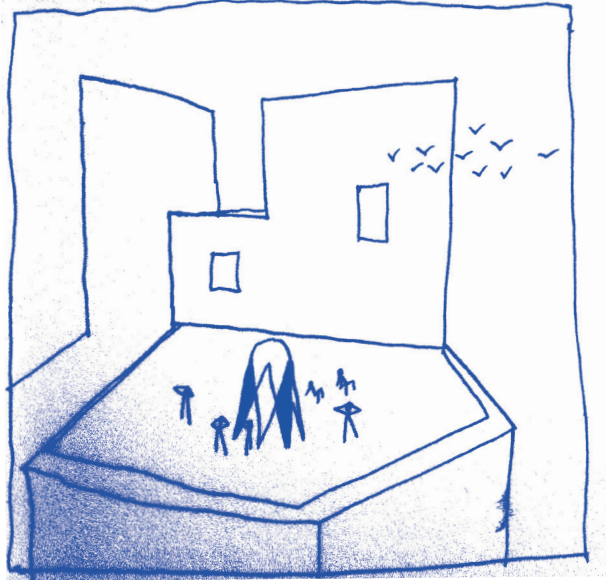

*We are attempting to survive our time so we may live into yours. We hope someday, having solved the problems we face, to join a community of galactic civilizations.*

*Jimmy Carter, Voyager Golden Record, 1972*

*At the heart of the major urban development project PAV ("it is a question of transforming the vastest and oldest industrial and artisanal zone of Geneva into a mixed-use neighborhood, it will be a good place to live and work"), the Étoile neighborhood becomes central. The sector assignments are being redesigned, creating uncertainty and sometimes the anxiety of the actors who sign up for it.*

At the invitation of the Embassy of Foreign Artists - Maison Baron (EOFA) residency programme and the Villa Bernasconi, art centre of the City of Lancy (Hors les murs project), Constructlab is taking part this summer in a three-month residency entitled Art and Territory. Our intervention revolves around the exploration of the territory of the Étoile neighborhood: we search for opportunities to experiment and make complexity sensitive to the undergoing mutations, their richness and strangeness. Many words have already been spoken by citizens, politicians, architects and urban planners on the size, height, density, legitimacy of such an urban development project. So, we have chosen to concentrate our explorations around the quietest, and nevertheless most present actor in the project: the stone. Accused of sterility and blamed for their austerity, the stone and materials that derive from it are generally opposed to anarchic spontaneity of the living. Passive, inert, cold: the mineral is among the elements that has been most easily domesticated by humanity. Its transformation into concrete, bitumen and cement - and the massive use of these, characterizes the society which has resulted from the industrial revolutions, from hygiene and the market economy. Although ubiquitous in urban areas, the mineral is very often negatively perceived. The heart of bad guys is even composed of it... Yet, what can a stone tell? From what deposits does a stone come from? Was it rolled down by the torrents, polished by the water - and then dredged from the bottom of a lake? Was it violently extracted, with huge machines, explosives... what route did it take? What was the ecosystem of its substrate? What influence can it have, once transformed into roads and buildings - on the animal and plant life? Who takes care of it? And that poor rock (not a stone, much less a rock) that we we picked up at the bottom of a staircase under construction: how did it find its way there, all alone, with a green line of paint on it to mark? Ruins and vestiges of interest to the archaeologist; unknown soils of the planets that the astronaut's foot is about to step on, a first for the times. Who else would consider the mineral with benevolence, as a serious interlocutor, a concrete actor?



## MISSIONS

The exploration of the minerality of the “Quartier de l’Étoile” is pursued by bringing together different protagonists: living and non-living actors, specialist, professionals and others. The explorations are neither driven by events nor specifically participatory: their uniqueness gives it a performative and non-repeatable dimension. During each “mission”, transdisciplinary teams of experts interact with the participants in order to develop always new protocols for the exploration of a multitude of aspects of the Étoile neighborhood, merging scientific and poetic approaches to the understanding of the territory.

24/07/2020  
LEÇON DU BÉTON  
CONCRETE LESSON

*With Yvonne Harder (Chorale Alice), Davide Tidoni (sound artist), Christian Zufferey (Décibel Acoustique)*

They say: dumb as a rock, but what influence does the mineralization of the world have on the sounds of our environment? All the world hears it well, the phenomena of various acoustics continuously being generated by the activity of the city, reverberated or absorbed by its frame. Is this dimension taken into account in the development of new urban developments and, if so, by whom? Is it engineers, physicists or musicians who will be able to enlighten us on sound waves and their propagation?

13/08/2020  
ÉTOILES ET MANUTENTION  
STARS AND MAINTENANCE  
*With Carine Roth (shaman), Eric Tenthorey (horticulturalist at the City of Lancy's Green Spaces Department), Albéric Hopf (Project Manager at PAV)*

Every vernacular agricultural practice involves a little astronomy: astral rhythms are followed to determine soil

preparation, planting, cultivation and harvesting of the fruits of the earth. At the City of Lancy's Green Spaces Department, some of the operators also use the stars to take care of the plants. However, the planned transformation of public spaces in the Étoile district includes squares, building borders, squares; giving the appearance that for the moment, minerals prevail over plants. How will this state of affairs influence the work of handling these spaces by the City of Lancy's horticulturalists? And how will the living species adapt to their new environment? Faced with the climatic challenges of the coming decades, we are working with the shaman Carine Roth to build an alliance between minerals and the living species - including humans - that design and inhabit these spaces.

20/08/2020  
SOUS LE PAV, LES RUISSEAU  
UNDER THE PAV, THE RIVERS  
*With Alexandre Oricchio (dowser), Lucie Eidenbenz (artist) and Greg Bussien (ADR Architects)*

Under the PAV run two rivers, the Aire and the Drize, which were channelled and buried at the beginning of the 20th

century to make way for the railway and the industrial zone. At a time when our cities are losing their function of industrial production and an ever-increasing number of citizens are demanding for access to swimmable rivers and lakes, wouldn't it be wise to bring this mineral in its liquid state - yes, water is part of the mineral world - back to the surface? “Blue gold” is the subject of geopolitical stakes because of its role in the organisation of the territory, but remains above all a vital resource and a source of well-being. We symbolically accompany the Aire from its confluence with the Arve to its source.

27/08/2020  
NAISSANCE D'UNE MONTAGNE  
BIRTH OF A MOUNTAIN  
*With Julien Fargetton (artist), Cédric Schnyder (geologist), Katia Naouri (architect), Alexandra Nievergelt (geographer), Nicolas Waechter (landscape architect)*

For the construction of the new public spaces around the Pont-Rouge station, marble and granite were extracted and transfigured the mountains. The new towers in the Étoile district - contemporary urban heights - are built on the ruins of the old ones, which were demolished to make way for them. The debris was transported elsewhere and piled up in the form of new, artificial mountains. What impact do these transformations have on the way space is imagined and produced ?

11/09/2020  
VOL D'OISEAU (BIRD'S-EYE VIEW)  
*With Diego Sologuren (architect), Manuela Bernasconi (choreographer), Lionel Maumary (ornithologist)*

The ancient practice of ornithomancy consists of reading omens from bird

watching. A bird's-eye view is the view of an object from above, as if the observer were a bird. This way of seeing, often used in the making of plans and maps, seems to be favored by architects and town planners who draw our cities. Sacred or profane, birds seem to know a lot about the transformations taking place in the Étoile district. But will they find their place in the new district? Will they be able to nest and fly among the new blocks and towers?

19/09/2020  
JEUX DE PIERRE  
GAME OF STONES  
*With Aline Morvan and Wendy Gaze, Martin Schick (artists)*

Small, smooth, round stones, stones that look like something else - like a cat, a face, a house -, stones that pile up in heaps or stack one on top of the other towards the sky, stones that are thrown far away, stones that bounce off the surface of the water ... stones often prove to be excellent partners in having fun, reliable play companions, already on the spot, always present. Game is an ancient and multifaceted cultural form, through which we reverse systems, challenge powers, test interactions and collaborative skills, confront each other in a playful way. This is why we should never stop training our ability to play, even in a structured, constrained daily life, where free time is rationed and actions timed. For our latest exploration of PAV, we invite you to a building site temporarily transformed into a playground.

## DEVICE

In order to explore the terrain in which we are immersed, a device for minimal logistics is required. Mobile, light, transportable, it holds both the space module and the archaeologist's camp. It is at the same time a living space, and a portable laboratory - open to the terrain that it allows us to examine. It makes our presence visible (banner, flag, totem pole) and keeps track of data previously collected at other places (archive function, testimony function). The device allows, by its modularity - the framing of a particular aspect, landscape, detail or an element of the investigated site. Without being closed, it also assumes to be a shelter, a camp, a place to live. It emphasizes habitability, even in places into which it temporarily fits. It is intended to be a generator of interactions, hazards and encounters. Extremely simple in terms of structure, the appearance of the module is constantly evolving: each of the exploratory sessions leaving a legacy of traces on the surface of the device.



*Sous le PAV, les ruisseaux (Dylan Perrenoud, 2020).*



*Naissance d'une montagne (Dylan Perrenoud, 2020).*



RÉPUBLIQUE  
ET CANTON  
DE GENÈVE

POST TENEBRAS LUX

VILLA BERNASCONI HORS LES MURS

Ville de Lancy



Embassy of  
Foreign Artists